

PROPOSED NEW SINGLE OCCUPANCY RESIDENTIAL DWELLING & GARAGE / STUDIO  
 FOR: MR. G. & MRS. S. HASLINGER  
 AT: LOT 62 KING STREET, MITTAGONG. 2575  
 DRAWING: COVER PAGE

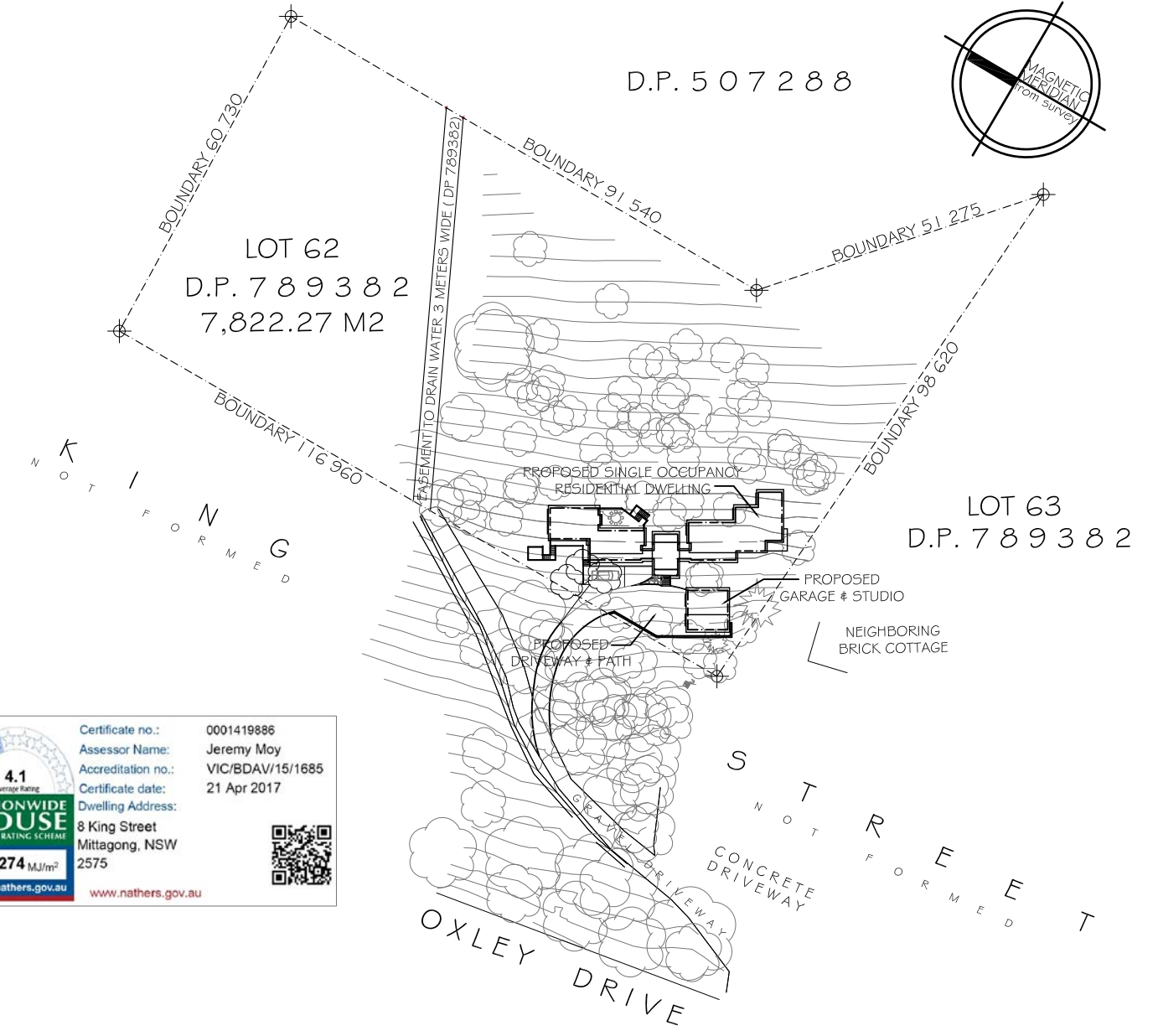

**3D PERSPECTIVE VIEWS OF PROPOSAL**



	Certificate no.:	0001419886
	Assessor Name:	Jeremy Moy
	Accreditation no.:	VIC/BDAV/15/1685
	Certificate date:	21 Apr 2017
	Dwelling Address:	8 King Street Mittagong, NSW 2575
	<a href="http://www.nathers.gov.au">www.nathers.gov.au</a>	<a href="http://www.nathers.gov.au">www.nathers.gov.au</a>

**SITE PLAN - SCALE 1 : 1,000 / A3**

- ALL WORKS TO BE IN ACCORDANCE WITH THE NATIONAL CONSTRUCTION CODE. LOCAL COUNCIL BUILDING APPROVAL, RELEVANT GOVERNING STATUTORY AUTHORITIES & MINIMUM STANDARDS OF CONSTRUCTION.
- FIGURED DIMENSIONS IN PREFERENCE TO ANY SCALE.
- THE BUILDER IS TO BE RESPONSIBLE FOR BUILDING DETAILS, CONSTRUCTION METHODS & SET OUT.
- THE BUILDER IS TO CHECK ALL DIMENSIONS & LEVELS FOR IN ACCURACIES PRIOR TO START.
- THE BUILDER IS TO INCLUDE & ARRANGE SEPARATE ENGINEERS DETAILS #/OR INSPECTIONS AS REQUIRED.
- EXISTING FOOTINGS & STRUCTURE TO BE CERTIFIED BY ENGINEER TO WITHSTAND ADDITIONAL LOADS.
- PROPOSED ADDITION & STRUCTURE TO BE CERTIFIED BY ENGINEER.



**EVOLVING DESIGN & DRAFTING**  
 NO: SHOP 6 - 459 GREAT WESTERN HIGHWAY,  
 FAULCONBRIDGE. NSW 2776  
 PH: (02) 4751 5842 FAX: (02) 4751 4310  
 MOBILE: 0406 339 865 ABN: 41 850 627 908

JOB No.	110/15
SHEET NO.	1/16
AMENDMENT	DA6
SCALE	1 : 1,000 / A3
DATE:	27.04.17