

STORMWATER CONCEPT PLAN - SCALE 1:200

RAINWATER TANK

- The applicant must install a rainwater tank of at least 5,000 litres on the site. This rainwater tank must meet, and be installed in accordance with, the requirements of all applicable regulatory authorities.
- The applicant must configure the rainwater tank to collect rainwater runoff from at least 260.00 square metres of roof area.
- The applicant must connect the rainwater tank to
 - At least one outdoor tap in the development (Note: NSW Health does not recommend that rainwater be used for human consumption in the areas with potable water supply.)

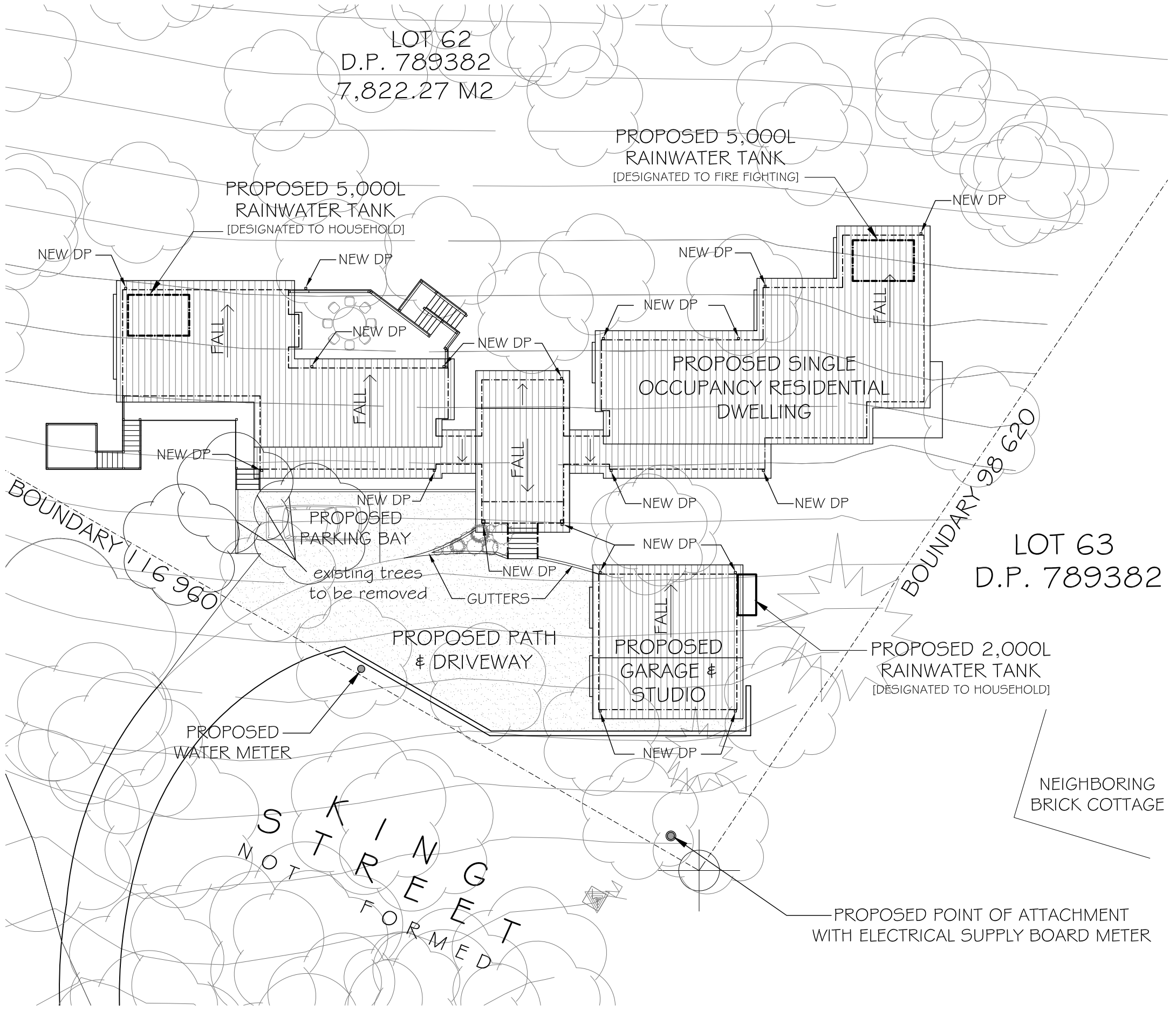
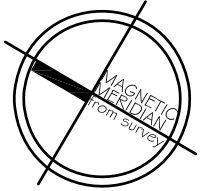

THIS DESIGN AND PRINTS ARE THE PROPERTY OF BLUE ECO HOMES (JOE MERCECA CONSTRUCTION PTY LTD). AND IS ISSUED FOR THE SOLE PURPOSE OF ENTERING INTO A BUILDING CONTRACT WITH THE COMPANY. IT MUST NOT BE USED OR REPRODUCED IN WHOLE OR IN PART WITHOUT PRIOR WRITTEN PERMISSION OF THE COMPANY

APPLICATION ONLY,
NOT FOR CONSTRUCTION



PROJECT: PROPOSED NEW SINGLE OCCUPANCY RESIDENTIAL DWELLING & GARAGE/STUDIO
DRAWING: STORMWATER CONCEPT PLAN
EVOLVING DESIGN & DRAFTING
NO: SHOP 6 - 459 GREAT WESTERN HIGHWAY, FAULCONBRIDGE. NSW 2776
PH: (02) 4751 5842 FAX: (02) 4751 4310
MOBILE: 0406 339 865 ABN: 41 850 627 908

FOR: MR. G & MRS. S. HASLINGER
AT: LOT 62 KING STREET, MITTAGONG 2575

SCALE 1 : 200 / A3
DATE: 27.04.17

JOB No. 110/15	
SHEET NO. A	AMENDMENT DA6